



Office and Healthcare
Seating Specialists

LOTUS CHAIR RANGE

See website for more details

LOTUS CAFE CHAIR

The Lotus Cafe Chair is available in Red, Blue, Black White and Green. They are easy to stack.

STANDARD FEATURES

- No arms
- Modern design
- Quality materials used for comfort and durability
- Suitable for cafés and restaurants
- Suitable for waiting rooms and foyers
- Suitable for schools and educational facilities
- 3 year warranty
- Made for Arteil

PRICE

\$77.00

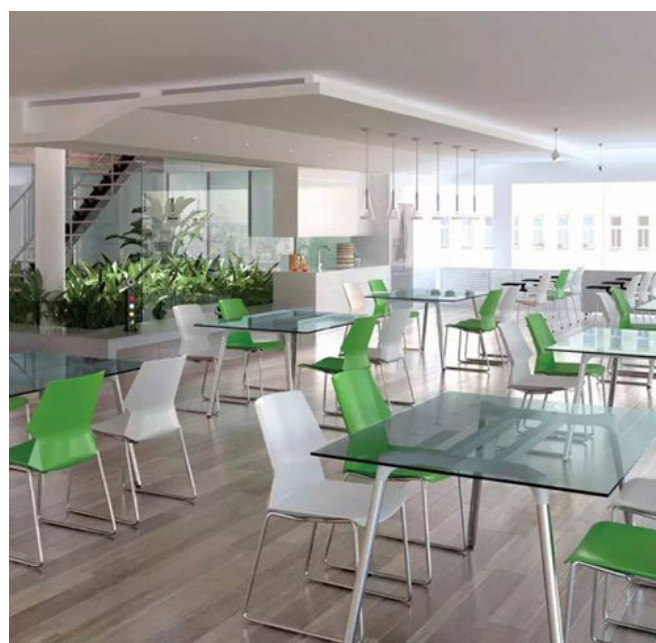

DIMENSIONS (mm)

	Overall Width	Back Width	Back Height	Seat Depth	Seat Width	Seat Height	Overall Height
Lotus Cafe Chair	490	490	440	420	420	440	-

ARTEIL

Office and Healthcare Seating Specialists

Unit 2-5
95 Garling St
O'Connor WA 6163

Tel: (08) 9337 8399

Fax: (08) 9314 1553

Email: sales@arteil.com.au

www.arteil.com.au

